

# AXIS Camera Station S1048 Recorder

## Out-of-the box ready server for high-definition surveillance

- > Ease of installation
- > Pre-configured
- > Optimized hardware
- > High-definition surveillance
- > AXIS Camera Station included
- > Extensive support



AXIS Camera Station S1048 Recorder is an out-the-box ready rack server optimized for reliable high-definition surveillance. AXIS S1048 is pre-loaded with all the necessary software and pre-configured to minimize installation time. Completed with cameras, a desktop terminal and monitors, it forms a plug and play solution for mid-sized installations where active surveillance is needed.

AXIS S1048 is designed for quick installation in server rooms. The recorder is pre-loaded with AXIS Camera Station video management software, 48-channel licenses and other necessary system software.

System settings such as camera and storage configurations are pre-configured to further simplify system setup and maximize performance. Hardware components and storage capacity are optimized to meet the demands for reliable high-definition surveillance.

To further safeguard system uptime the server has redundant hard disks and power supplies. The package includes three-year hardware and software support.

AXIS Camera Station offers an intuitive user interface providing all the necessary features for effective surveillance such as flexible live-view layout, site maps, powerful event configuration, efficient alarm management and responsive PTZ control.

Intuitive timeline visualization and an efficient video search enable quick investigation and retrieval of evidence for safe and secure export.

AXIS S1048 can be completed with AXIS Camera Station S9001 Desktop Terminal with multiple monitor support for optimal system overview.



AXIS S9001 Desktop Terminal sold separately

## Technical Specifications - AXIS Camera Station S1048 Recorder

### Network Video Recorder - Rack Server

<b>Model</b>	AXIS Camera Station S1048 Recorder Version: 2
<b>Number of channels</b>	48 Channels included, can be upgraded up to 64 channels (sold separately)
<b>Processor</b>	Intel® Xeon® Processor E5-2609 v3 1.90 GHz, 15MB Cache
<b>Memory</b>	2 x 4GB (8192MB) Memory type: RDIMM 2133MT/s, Dual Rank, x8 Data Width
<b>Storage</b>	5 x 4TB (16TB usable space after RAID) 7200rpm HDD with 64MB cache and SATA 6Gb/s interface, RAID 5, Hot Plug Raid Controller: PERC H730, 1GB NV Cache
<b>Graphic card</b>	Matrox 200 eR
<b>Optical Disk Drive</b>	OEM DVD RW
<b>Operating System</b>	Microsoft Windows Professional Embedded 7
<b>Network Card</b>	On-Board Broadcom 5720 Quad Port 1Gb/s LOM
<b>Remote Management</b>	iDrac 8 Express

### System Performance Specifications

<b>Live Video streams</b>	Not intended for local viewing of video.
<b>Recording</b>	Qualified for recording up to 64 video channels with a total recording rate up to 256 Mbit per second.

### AXIS Camera Station - Video Management Software

<b>Software</b>	Axis Camera Station 4.x
<b>Languages</b>	All major languages
<b>Video</b>	
<b>Audio</b>	Two-way audio streaming, AAC, G.711, G.726 compression
<b>Video compression</b>	H.264 (MPEG-4 Part 10/AVC), Motion JPEG
<b>Live view</b>	
<b>Map function</b>	Yes
<b>PTZ Control</b>	Yes
<b>Playback</b>	
<b>Smart Search for recordings</b>	Yes
<b>Playback</b>	Up to 64x or frame by frame Up to 25 cameras synchronized playback
<b>Export</b>	Manual and scheduled export, Single images in JPEG format, Video in ASF format, Digital signature on exported recordings, Standalone player

### General

<b>Compatible Products</b>	Axis network cameras and encoders including HD, standard resolution, high resolution, Pan Tilt Zoom and thermal cameras with firmware 4.30 or later
<b>Power</b>	Dual, Hot-plug, Redundant Power Supply, 495 W
<b>Connectors</b>	4 x USB 2.0, 2 x VGA, Serial port (DB9), 4 x Ethernet (RJ45), 2 x Power inlet
<b>Operating conditions</b>	10 °C to 35 °C (50 °F to 95 °F)
<b>Dimensions</b>	87 x 483 x 611 mm (3.42 x 19 x 24 in), 2U Chassi
<b>Weight</b>	18.8 kg (41.45 lb)
<b>Approvals</b>	EN/IEC/UL 60950-1, CSA C22.2 No. 60950-1, EN 62311, EN 55022, CISPR 22, EN 55024, CISPR 24, EN/IEC 61000-3-2, EN/IEC 61000-3-3, EN 50581, IEC60664-1
<b>Hardware warranty</b>	3-years included

### Accessories

<b>Included accessories</b>	Installation guide, Power cable
<b>System accessories</b>	AXIS T8310 Video Surveillance Control Board, AXIS P8221 I/O Audio Module, AXIS A1001 Network Door Controller, AXIS Camera Station S9001 Desktop Terminal

### Triggers and events

<b>Event triggers</b>	Events triggered by video motion detection, Active Tampering Alarm, AXIS Cross Line Detection, External I/O, Action button, System triggers and device event triggers
<b>Scheduled recording</b>	Schedule per camera for continuous recording or customization of weekday and weekend recordings
<b>Alarm manager</b>	Yes
<b>Microsoft Active Directory support</b>	Yes, multiple user access levels with password protection using local or Windows domain users (Active directory)

More information is available at: [www.axis.com/products/cam\\_station\\_software](http://www.axis.com/products/cam_station_software)

### System setup with AXIS S1048 and AXIS S9001

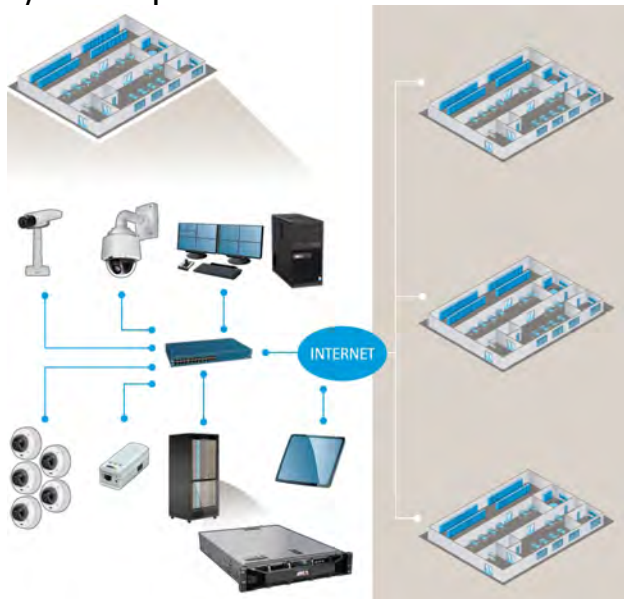

### Live view example



### Playback example

