

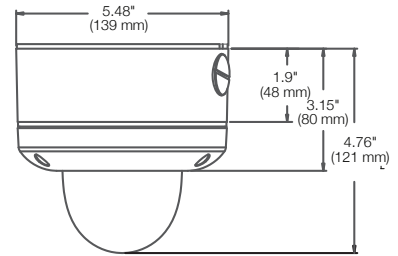

Dimensions

unit : Inch (mm)



Snapit Easy Installation

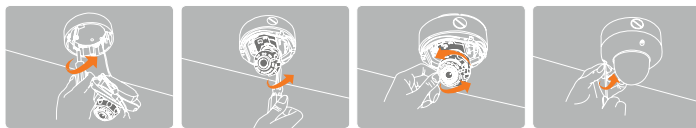

- 1 Built-in Junction Box Installation
- 2 Snap It
- 3 Adjustment
- 4 Cover

Summary

MEGApix® IP cameras provide 4 megapixel resolution at up to real-time 30fps. The IP68-rated Snapit™ housing is easy to install and features CleanView™ dome treatment and Cold Start at -40° F/-40° C. All MEGApix® cameras are ONVIF conformant, assuring their successful integration with any open platform solution on the market.

Features

- 4MP 1/3" CMOS Sensor at Real-Time 30fps
- 2.8-12mm Remote Auto Focus P-Iris Lens
- Wide Dynamic Range
- Dual Codecs (H.264, MJPEG) with Simultaneous Streaming
- Cold Start -40°F (-40°C)
- CleanView™ Hydrophobic Dome Coating Repels Water, Dust and Grease
- Snapit™ Easy Installation Housing
- Smart DNR™ 3D Digital Noise Reduction
- Micro SD/SDHC/SDXC Class 10 Card Slot for Event and Continuous Recording(Card Not Included)
- Junction Box Built-in
- Alarm Sensor Input
- Relay Output
- OnVIF Conformant, Profile S
- IP68 Certified (Water Resistant)
- 5 Year Warranty



Accessories (Optional)

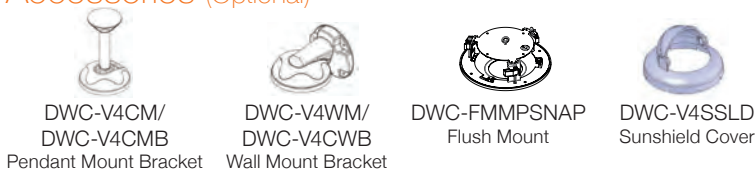

Specifications

IMAGE	
Image Sensor	1/3" 4MP CMOS
Total Pixels	2688(H) x 1520(V)
Minimum Scene Illumination	F1.4 (30IRE): 0.2 Lux [Color]
LENS	
Focal Length	2.8-12mm
Lens Type	P-Iris Auto Focus
Field of View (FoV)	87° ~ 32°
Optical Zoom	x4.2
AUDIO	
Audio In/ Out	1/1
Audio Compression	G.711
OPERATIONAL	
Shutter Mode	Auto, Manual, Anti-Flicker
Shutter Speed	1/15-1/32000
Auto Gain Control	Auto
Day and Night	Auto, Day (Color), Night (B/W)
Smart DNR™ 3D Digital Noise Reduction	0-11
Wide Dynamic Range (WDR)	Off, WDR2x, WDR3X
Privacy Zone	4 Programmable Privacy Masks
Alarm Notifications	Notifications Via E-mail, FTP Server or SD Card Recording
NETWORK	
LAN	802.3 Compliance 10/100 LAN
Video Compression Type	H.264, MJPEG
Resolution	2560x1440 at 30fps 800x600 at 30fps 480p at 30fps
Frame Rate	Up to 30fps at All Resolutions
Streaming Capability	Dual-Stream at Different Rates and Resolutions
IP	IPv4
Protocol	ONVIF, TCP/IP, UDP, RTP/RTSP(TCP/UDP), NTP, HTTP, DNS, DDNS, DHCP, FTP, SMTP, ICMP
Security	Password authentication, Multi-level user configuration
Maximum User Access	5 Users
ONVIF Conformance	Yes
Web Viewer	OS: Windows®, Mac® OS, Linux® Browser: Internet Explorer®, Google Chrome®, Mozilla Firefox®, Safari®
Video Management Software	DW Spectrum™ IPVMS
Memory Slot	Micro SD / SDHC / SDXC, Card not Included
ENVIRONMENTAL	
Operating Temperature	-40°F ~ 122°F (-40°C ~ 50°C)
Operating Humidity	Less than 90% (Non-Condensing)
IP Rating	IP68 (Water Resistant)
Other Certifications	CE, FCC, RoHS
ELECTRICAL	
Power Requirement	DC 12V, PoE (IEEE802.3af)
Power Consumption	Auto Focus Working MAX 6.2W/AF Off: 3.6W
MECHANICAL	
Material	Aluminum Housing, Polycarbonate Dome
Dimensions	5.47 x 4.8 Inch (139 x 121.8 mm)
Weight	2.75 lbs (1.25kg)