

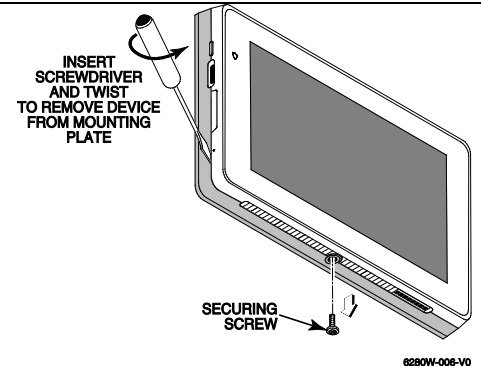

MOUNTING

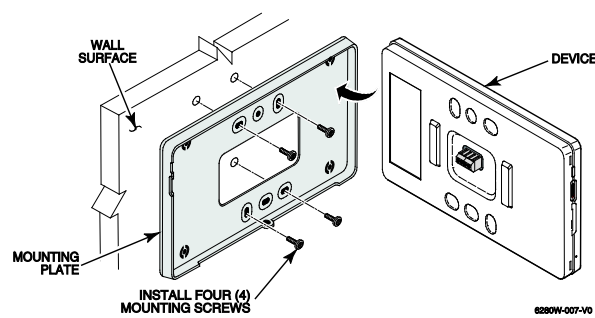
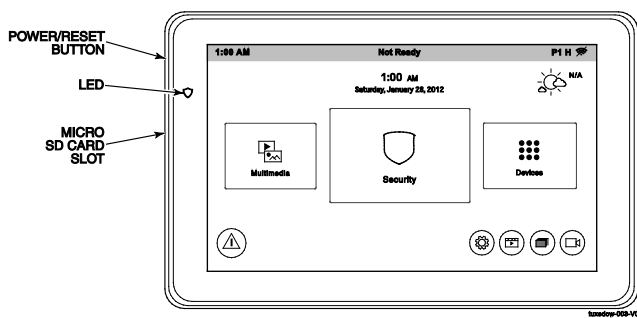

OPERATING THE TOUCHSCREEN

For operating instructions, see the User Guide for the control panel used with this Touchscreen.

NOTE: If the touchpad is defaulted, it will cause the Z-Wave module to default.

This TUXEDOW Touchscreen is for indoor use only and should be mounted at a comfortable viewing level. Avoid mounting in areas of high condensation such as bathrooms or in locations where bright light or sunlight shines directly on the screen. The Touchscreen is surface mounted directly to a wall.

Locate the mounting plate and attach to a wall using the 4 screws provided. Insert bottom side of Touchscreen over the mounting plate and then click in top side to snap into place. Install the cover securing screw at the bottom of the device to secure. The bottom securing screw must be installed.

To remove the Touchscreen from its mounting location, insert the end of a screwdriver between the plate and the touchscreen and twist to loosen and pull out to remove.

WIRING

CONNECT WIRING

Route wiring from the controller through the opening in the mounting plate.

Connect the Touchscreen in parallel with Touchscreens and other peripheral devices using the Touchscreen data (ECP) bus. If more than one Touchscreen is wired to one run, then the maximum lengths must be divided by the number of devices on the run. (e.g., the maximum length is 75 feet if two devices are wired on a #22 gauge run).

Wire Gauge	Length
#22 gauge	150 feet
#20 gauge	240 feet
#18 gauge	350 feet
#16 gauge	550 feet

SPECIFICATIONS

Mechanical Specifications:	
Width:	7.91 inches (200.9mm)
Height:	5.04 inches (128.016mm)
Depth:	.827 inches (21.00mm)
Electrical specification:	
Backlight ON, Sound ON	12V, 270mA
Operating Environment:	
Humidity:	93% RH, non-condensing
Operating Temp.	14°F to 131°F / -10°C to 55°C (UL tested 32°-120°F / 0° to 49°C)
Ship/Storage/Temp.:	40°F to 158°F / -40°C to 70°C

Install in accordance with NFPA-70 and NFPA-72.

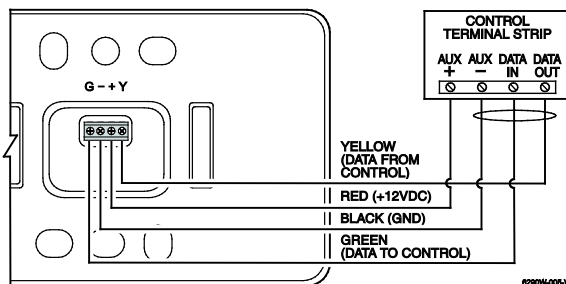

Refer to the control panel Installation Guide for additional Information.

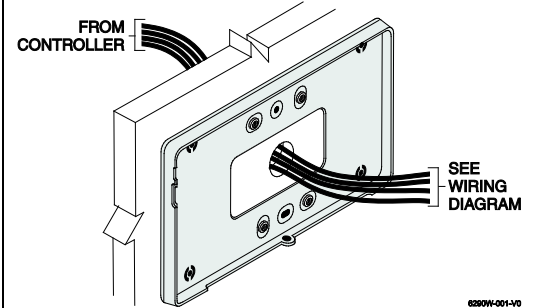

This equipment should be installed in accordance with National Electrical Code, NFPA 70, Standard for the Installation of Residential Fire Warning Systems, CAN/ULC-S540 and Chapter 2 of the National Fire Alarm Code, ANSI/NFPA 72 (National Fire Protection Association, Batterymarch Park, Quincy, MA 02269). Printed information describing proper installation, operation, testing, maintenance, evacuation planning, and repair service is to be provided with this equipment.

Warning: Owner's instruction notice: 'Not to be removed by anyone except occupant'
This system must be checked by a qualified technician at least once every three (3) years.
Note: The product should not be disposed of with other household waste. Check for the nearest authorized collection centers or authorized recyclers. The correct disposal of end-of-life equipment will help prevent potential negative consequences for the environment and human health.

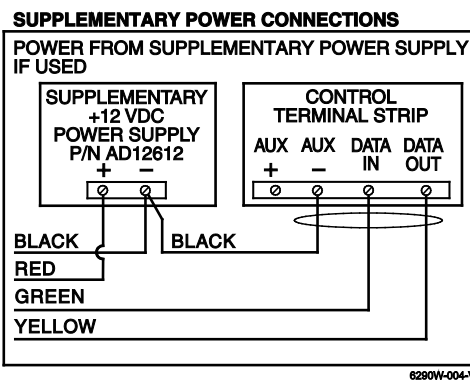

Wi-Fi® and the Wi-Fi logo are registered trademarks of Wi-Fi Alliance.

Compatibility

The table below identifies the alarm systems that the Touchscreen can interface with, the maximum number of Touchscreens that can be used with each system, and the minimum alarm panel software revision level for compatibility.

Panel Type	Panel Version	Max # of touchscreens
15p	V3 and higher	2
20p	V3 and higher	4
21ip	V1 and higher	4
128BPT	V10 and higher	6
250BPT	V10 and higher	6
128FBPT	V10 and higher	6
250FBPT	V10 and higher	6

Warning: 5G Band 5150-5250 MHz is only for indoor use.

REFER TO INSTALLATION INSTRUCTIONS FOR THE CONTROL PANEL WITH WHICH THIS DEVICE IS USED FOR WARRANTY INFORMATION AND LIMITATIONS OF THE ENTIRE ALARM SYSTEM.

Use a UL Listed, battery-backed supply for UL installations. The battery supplies power to these keypads in case of AC power loss. The battery-backed power supply should have enough power to supply the keypads with the UL required minimum standby power time.
IMPORTANT: Touchscreens powered from supplies that do not have a backup battery do not function if AC power is lost. Make sure to power at least one keypad in each partition from the control's auxiliary power output or UL Listed battery backed up power supply.

FEDERAL COMMUNICATIONS COMMISSION & ISED CANADA STATEMENTS

The user shall not make any changes or modifications to the equipment unless authorized by the Installation Instructions or User's Manual. Unauthorized changes or modifications could void the user's authority to operate the equipment.

CLASS B DIGITAL DEVICE STATEMENT

This equipment has been tested to FCC requirements and has been found acceptable for use. The FCC requires the following statement for your information. This equipment generates and uses radio frequency energy and if not installed and used properly, that is, in strict accordance with the manufacturer's instructions, may cause interference to radio and television reception. It has been type tested and found to comply with the limits for a Class B computing device in accordance with the specifications in Part 15 of FCC Rules, which are designed to provide reasonable protection against such interference in a residential installation. However, there is no guarantee that interference will not occur in a particular installation. If this equipment does cause interference to radio or television reception, which can be determined by turning the equipment off and on, the user is encouraged to try to correct the interference by one or more of the following measures:

- If using an indoor antenna, have a quality outdoor antenna installed.
- Reorient the receiving antenna until interference is reduced or eliminated.
- Move the radio or television receiver away from the receiver/control panel.
- Move the antenna leads away from any wire runs to the receiver/control panel.
- Plug the receiver/control panel into a different outlet so that it and the radio or television receiver are on different branch circuits.
- Consult the dealer or an experienced radio/TV technician for help.

ISED CLASS B STATEMENT

This Class B digital apparatus complies with Canadian ICES-003.
Cet appareil numérique de la classe B est conforme à la norme NMB-003 du Canada.

FCC / ISED STATEMENT

This device complies with Part 15 of the FCC Rules, and ISED's license-exempt RSSs. Operation is subject to the following two conditions: (1) This device may not cause harmful interference (2) This device must accept any interference received, including interference that may cause undesired operation.
Cet appareil est conforme à la partie 15 des règles de la FCC et exempt de licence RSS d'ISED. Son fonctionnement est soumis aux conditions suivantes: (1) Cet appareil ne doit pas causer d'interférences nuisibles. (2) Cet appareil doit accepter toute interférence reçue y compris les interférences causant une réception indésirable.

Responsible Party / Issuer of Supplier's Declaration of Conformity: Ademco Inc., a subsidiary of Resideo Technologies, Inc., 2 Corporate Center Drive., Melville, NY 11747, Ph: 516-577-2000
Partie responsable / Émetteur de la déclaration de conformité du fournisseur : Ademco Inc., une filiale de Resideo Technologies, Inc., 2 Corporate Center Drive., Melville, NY 11747, Tél. 516 577-2000

SUPPORT & WARRANTY

For the latest warranty information, please go to:
<https://www.security.honeywellhome.com/hsc/resources/wa/index.html>
For patent information, see <https://www.resideo.com/patent>

SUPPORT: For technical support, call 1-800-645-7492 M-F 8:30am to 5pm EST

UL Note: For residential burglar alarm applications, the entry delay time shall not exceed 15 seconds, therefore use is restricted to compatible listed control units capable of being programmed for this time parameter.
Connect only keypads to: Aux. + / Aux. - and Data input / Data output.

resideo

2 Corporate Center Drive, Suite 100
P.O. Box 9040
Melville, New York 11747
© 2019 Resideo Technologies, Inc
www.resideo.com

This product manufactured by Resideo and its affiliates. The Honeywell Home Trademark is used under license from Honeywell International Inc.



800-25178B 4/19 Rev B