

Explosion Proof Instrument Enclosure

Class I, II, III Div 1 & 2 - Trunnion - Glass Lens

Instruction Manual

Thank you for your purchase of the Larson Electronics EPL-AED series corrosion resistant device enclosure. Please follow the steps below in order to operate and maintain this product.

WARNING!

1. TO PREVENT RISK OF ELECTRICAL SHOCK DEACTIVATE/DISCONNECT POWER SUPPLY BEFORE INSTALLING OR PERFORMING MAINTENANCE (WHEN APPLICABLE).
2. THIS ENCLOSURE SHOULD BE INSTALLED BY QUALIFIED TECHNICIANS IN STRICT ACCORDANCE WITH THE NATIONAL ELECTRICAL CODE AND ANY LOCAL REQUIREMENTS WHEN ENERGIZED EQUIPMENT IS INSTALLED.
3. FOLLOW ALL LOCAL, STATE, AND NATIONAL ELECTRIC CODE FOR INSTALLING ENCLOSURE WITHIN HAZARDOUS AREAS.

INSTALLATION

- Unpack enclosure.
- To remove cover, loosen set screw on side of enclosure and rotate cover counter-clockwise.
- Thread conduit through NPT ports.
- Mount box with suitable hardware using the trunnion mount.
- See diagrams for additional information.

Approvals allow for field modifications on box for drilling and tapping conduit openings on side or back of enclosure without voiding UL-CSA-FM approvals.

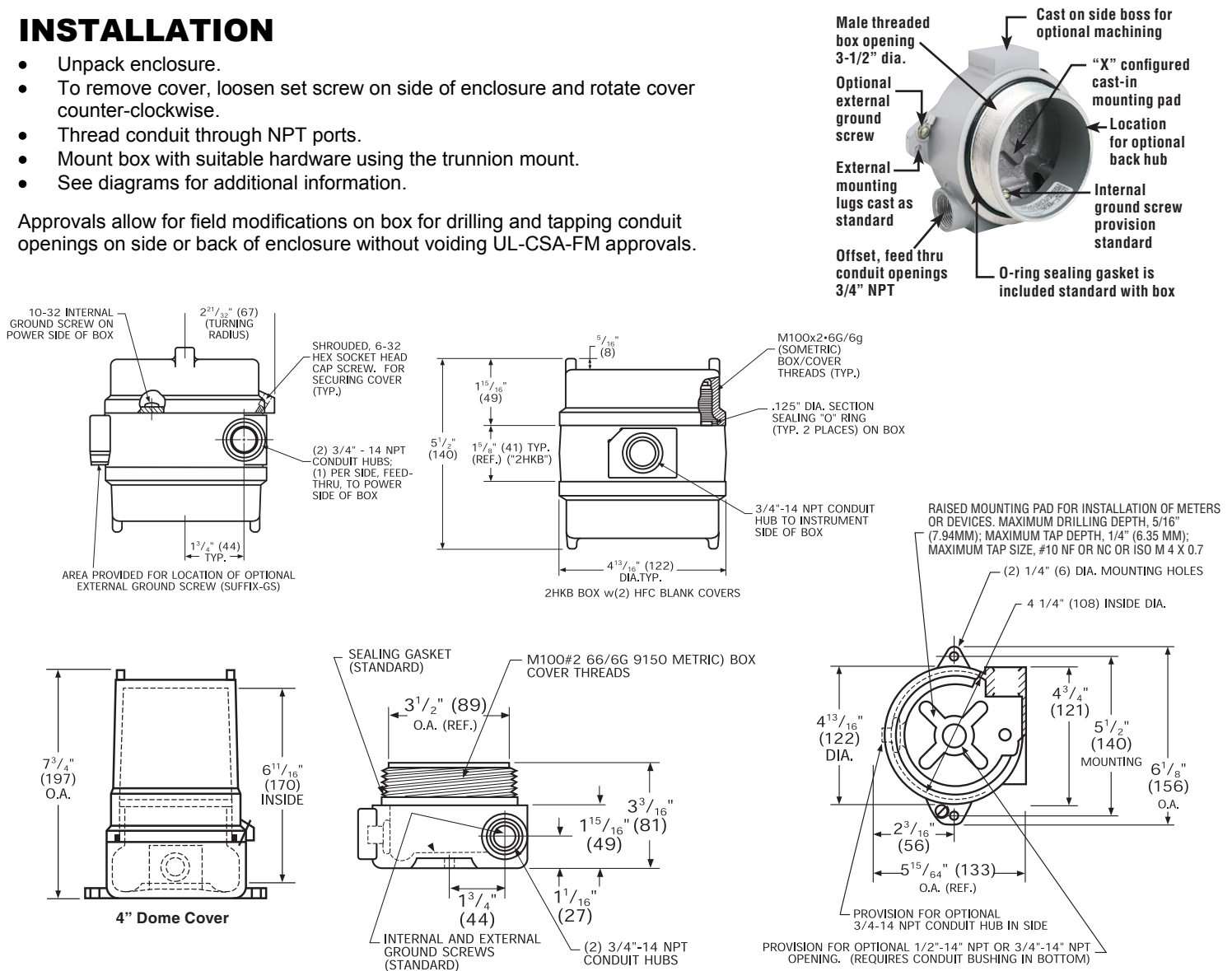

MAINTENANCE

Electrical and mechanical inspection of all components must be performed on a regularly scheduled basis, determined by the environment and frequency of use. It is recommended that inspection be performed a minimum of once a year.

THESE INSTRUCTIONS MAY NOT COVER ALL DETAILS OR VARIATIONS OF THIS PRODUCT FOR YOUR EQUIPMENT OR INSTALLATION REQUIREMENTS. SHOULD FURTHER INFORMATION NOT COVERED BY THESE INSTRUCTIONS BE REQUIRED, PLEASE CONTACT LARSON ELECTRONICS BY EMAIL AT SALES@LARSONELECTRONICS.COM OR BY PHONE AT 1-800-369-6671 FOR FURTHER ASSISTANCE.

PLEASE VISIT LARSONELECTRONICS.COM FOR **WARRANTY** AND **RETURN** INFORMATION.