

# CMIP1043W-MZ Turret Network Camera

## Quick Installation Guide

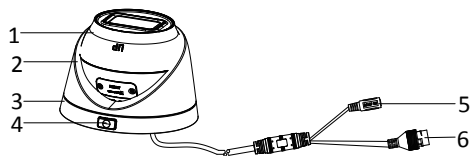

No.	Description
1	Camera Body
2	Enclosure
3	Mounting Base
4	Lock Button
5	Network Cable
6	Power Cord
7	Memory Card Slot Cover
8	Reset Button

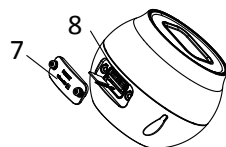

### Installation Ceiling Mounting Steps:

#### 1. Install the Memory Card

1.1 Rotate the camera body to completely expose the memory card slot



1.2. Loosen the screws to remove the memory card slot cover.

1.3. Insert the memory card into the slot, and push to get it mounted.

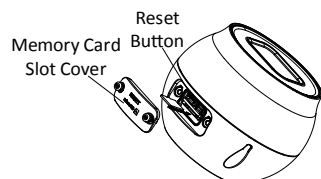

1.4 Screw the cover back to the camera.

#### 2. Ceiling Mounting

2.1. Disassemble the camera by pressing the button on the camera.

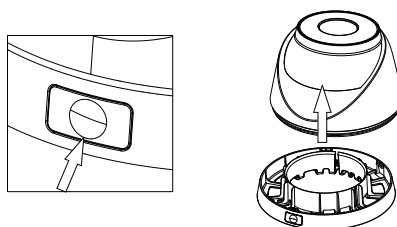

2.2. Paste the supplied drill template to the desired mounting position on the ceiling.

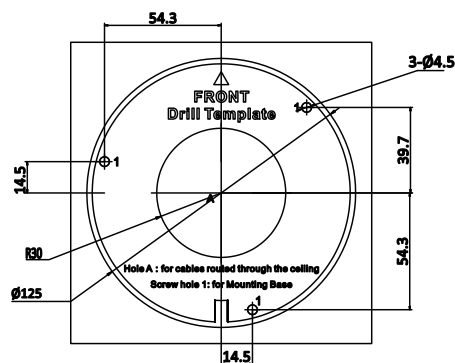

2.3. Drill the screw holes in the ceiling according to the drill template.

2.4. Fix the mounting base on the ceiling with supplied screws.

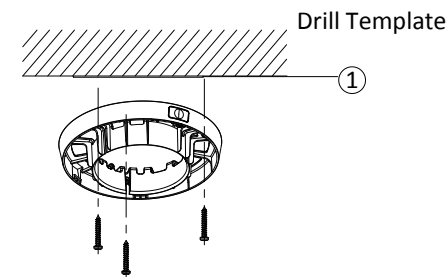

2.5. Route and connect the cables.

2.6. Install the camera body to the mounting base.

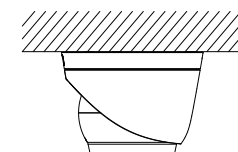

2.7. Rotate to adjust the surveillance angle.

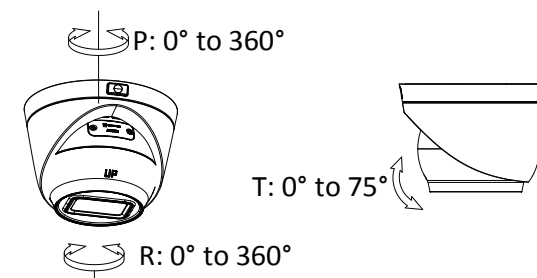

**Press Reset button for about 10s when the camera is powering on or rebooting to restore the default settings, including the user name, password, IP address, port No., etc.**

For detailed instructions of further configuration, please refer to the user manual of network camera.