

**WORLD'S
FIRST!**



DWC-PB753WTW



6MP Total Resolution **180°** Panoramic View **STAR-LIGHT™** Super Low Light Technology **3x** 4.3mm Fixed Lenses **IP66** Rated **5YEAR** Warranty

Summary



STAR-LIGHT PANO™ Cameras use three 2MP CMOS sensors and three 4.3mm fixed lenses to produce stunning 180° views at up to 30fps.

Digital Watchdog® AHD cameras are engineered to work with VMAX A1™ All-in-One DVRs that record all analog to 960H, AHD and TVI up to 1080p. AHD provides an easy upgrade from analog to high definition video using existing infrastructure.

Features

- Analog High Definition (AHD) HD over Coax Technology
- 3x2MP Panasonic 1/3" CMOS Sensor
- 6MP 180° Panoramic Camera
- STAR-LIGHT™ Super Low Light Technology
- 3x 4.3mm Fixed Lenses
- Wide Dynamic Range (WDR)
- OSD Control Via Coaxial (UTC)
- Smart DNR™ 3D Digital Noise Reduction
- Highlight Masking Exposure (HME)
- True Day/Night Mechanical IR Cut Filter
- De-Fog™ Extreme Weather Image Compensation
- Auto Sensing 24VAC/12VDC with Line Lock
- 4th output for 180° Panoramic View
- Easy Icon Driven OSD Menu with Built-in Joystick
- Programmable Privacy Zones
- Auto Gain Control (AGC)
- Backlight Compensation (BLC)
- Dynamic Range Compressor (DRC) Reveals Low Light Detail
- Auto White Balance (AWB)
- 5 Year Warranty
- IP66 Certified (Weather Resistant)

Dimensions

unit : mm (inch)

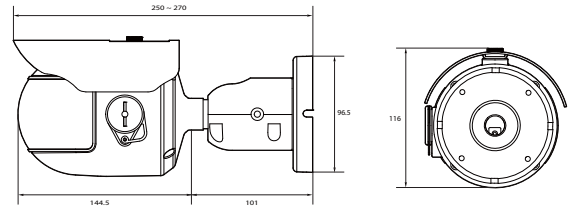

Specifications

IMAGE	
Image Sensor	3x Panasonic 1/3" CMOS Sensors
Active Pixels	3X 1944 (H) x 1092 (V)
Scanning System	Progressive Scan
Frequency	60Hz / 50Hz
Signal Technology	6.0 Megapixel AHD (3 x 2MP Sensors)
Synchronization	Internal
Resolution	6.0 Megapixel (3x 1920x1080 Sensors)
Minimum Scene Illumination	F2.0 (30IRE): 0.06 Lux [Color] F2.0 (30IRE): 0.01 Lux [B&W]
S/N Ratio	55dB
Video Output	AHD6MP (3x 1080p at 30fps + 4ch / 180° Pan-
Alarm Output	3 Alarm Output
LENS	
Focal Length	4.3mm
Lens Type	Fixed Lens
OPERATIONAL x3 (Below specs are for each sensor)	
Shutter Speed	1/30(25) – 1/30,000
Backlight	Off / On
STAR-LIGHT (Sense-up)	Off, x2 – x32
Wide Dynamic Range (WDR)	Off / On
Digital Noise Reduction	Off, Low, Middle, High
White Balance	Auto / Auto-Ex / Preset / Manual
Day and Night	Day / Night / Auto
Mirror / Flip	Yes
Auto Gain Control	Max 60dB
Motion Detection	3 Zones per Camera, Total 12 Motion Zones
Privacy Zones	16 Masks per Camera, Total 72 Privacy Masks
Sharpness	0 ~ 10
Gamma	0.5
RS485 / UTP Built-in	PELCO D / A-PC
ENVIRONMENTAL	
Operating Temperature	-20°C ~ 50°C (-4°F ~ 122°F)
Operating Humidity	Less than 90% (Non-Condensing)
IP Rating IP66	IP66 (Weather Resistant)
Other Certifications	FCC, CE, ROHS
ELECTRICAL	
Power Requirements	DC12V / AC24V Dual Voltage
Power Consumption	DC12V: 8.5W, 708mA AC24V: 8.5W, 354mA
MECHANICAL	
Material	Aluminum
Dimensions	9.9 x 3.58 Inch (252 x 91mm)
Weight	2.2 lbs (1 Kg)

Accessories (Optional)

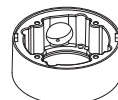

DWC-BLJUNC
Junction Box for B1, B2, B5 and
B6 and Panoramic Bullet Cameras