



**-40°**  
Cold Start

**Snapit™**

**2.1**



**5 YEAR**

Megapixel Universal HD / Analog STAR-LIGHT™ WDR IP68 Rated Warranty

## Summary

STAR-LIGHT™ 2.1MP Universal HD over COAX® cameras deliver crystal clear images and support real-time 30fps HD-Analog, HD-TVI, HD-CVI and all analog signals to 960H. Our unique Snapit™ housing is IP68 rated and makes installation a snap!. STAR-LIGHT™ Universal HD over COAX® cameras are engineered to work with our VMAX A1™ Universal HD over COAX® DVRs using your existing coax infrastructure for a cost-effective, high resolution surveillance solution.

## Features

- Universal HD over Coax® Technology with HD-Analog, HD-TVI, HD-CVI and all Analog to 960H Signal Support
- STAR-LIGHT™ Super Low Light Technology
- 2.1MP 1/3" Image Sensor at Real-time 30fps
- 2.8~12mm Motorized Zoom Auto-Focus P-Iris Lens
- True Wide Dynamic Range (WDR)
- OSD Control Via Coaxial (UTC)
- Snapit™ Easy Installation Housing
- CleanView™ Hydrophobic Dome Coating Repels Water, Dust and Grease
- Cold Start -40°F (-40°C)
- 100' Smart IR™ with Intelligent Camera Sync.
- Smart DNR™ 3D Digital Noise Reduction
- True Day/Night Mechanical IR Cut Filter
- De-Fog™ Extreme Weather Image Compensation
- Highlight Masking Exposure (HME)
- Auto Sensing 24VAC/12VDC with Line Lock
- Easy Icon Driven OSD Menu with Built-in Joystick
- Programmable Privacy Zones
- Auto Gain Control (AGC)
- Backlight Compensation (BLC)
- Dynamic Range Compressor (DRC) Reveals Low Light Detail
- Auto White Balance (AWB)
- UTP Built-In
- Junction Box Built-in
- RS-485 Built-in
- IP68 Certified Water and Tampering Resistant
- IK-10 Impact Rated
- 5 Year Warranty

## Accessories (Optional)



DWC-V4SSLD  
Sunshield Cover for Snapit  
Outdoor Dome Cameras



DWC-V4CM  
Ceiling Mount for Snapit  
Outdoor Dome Cameras



DWC-V4WM  
Wall Mount for Snapit  
Outdoor Dome Cameras



DWC-FMSNAP Ceiling  
Flush Mount for Snapit  
Outdoor Dome Cameras

## Dimensions

unit: Inch (mm)

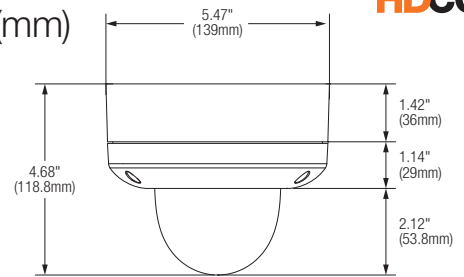

## Specifications

| IMAGE                                 |  |
|---------------------------------------|--|
| Image Sensor                          | 2.1MP 1/3" CMOS Sensor   |
| Active Pixels                         | 1944 (H) x 1092 (V)  |
| Scanning System                       | Progressive Scan   |
| Frequency                             | 60Hz / 50Hz  |
| Video Output                          | HD-Analog, HD-TVI, HD-CVI 2.1MP 1080p<br>CVBS Analog up to 960H                                |
| Synchronization                       | Internal   |
| Resolution                            | 1920x1080 (1080p)  |
| Minimum Scene Illumination            | F1.4 (30IRE): 0.03 Lux (Color)<br>F1.4 (30IRE): 0 Lux (B/W)                                    |
| S/N Ratio                             | 55dB   |
| Signal Technology                     | 2.1MP 1080p HD with HD-Analog, HD-TVI, HD-CVI<br>and all Analog to 960H Signal Support         |
| Alarm Output                          | 1 Alarm Output   |
| LENS                                  |  |
| Focal Length                          | 2.8 ~ 12mm   |
| Lens Type                             | Motorized Zoom Auto-Focus P-Iris Lens  |
| IR Distance                           | 100ft IR   |
| OPERATIONAL                           |  |
| Shutter Speed                         | 1/30 ~ 1/30,000  |
| Backlight                             | Off / On   |
| STAR-LIGHT™ (Sense-up)                | Off, x2 ~ x32  |
| Wide Dynamic Range (WDR)              | Off / On   |
| Wide Dynamic Range dB                 | 100dB  |
| Smart DNR™ 3D Digital Noise Reduction | Off, Low, Middle, High   |
| White Balance                         | Auto / Auto-Ex / Preset / Manual   |
| Day and Night                         | Day / Night / Auto   |
| Mirror / Flip                         | Yes  |
| Auto Gain Control                     | Max 60dB   |
| Motion Detection                      | Yes  |
| Privacy Zones                         | 16 Privacy Zones   |
| Sharpness                             | 0 ~ 10   |
| Gamma                                 | 0.45 ~ 0.75  |
| RS485 / UTP Built-in                  | PELCO D / PELCO C  |
| ENVIRONMENTAL                         |  |
| Operating Temperature                 | -40°F ~ 122°F (-40°C ~ 50°C)   |
| Operating Humidity                    | Less than 90% (Non-Condensing)   |
| IP Rating                             | IP68 Certified Water and Tampering Resistant   |
| IK Rating                             | IK10-Rated Impact Resistant  |
| Other Certifications                  | FCC, CE, ROHS  |
| ELECTRICAL                            |  |
| Power Requirements                    | DC12V / AC24V Dual Voltage   |
| Power Consumption                     | DC12V (LED OFF): 3.0W<br>DC12V (LED ON): 5.2W<br>AC24V (LED OFF): 2.3W<br>AC24V (LED ON): 4.6W |
| MECHANICAL                            |  |
| Material                              | Aluminum   |
| Dimensions                            | 5.47 x 4.68 inch (139 x 118.8 mm)  |
| Weight                                | 2.05lbs (0.93kg)   |