

DK Prox CARD READERS INSTALLATION

DoorKing Part Numbers

1815-300

mullion style card reader

1815-301

single-gang style card reader

1815-302

small card reader

DoorKing's DK Prox Card Readers are designed to manage an access point using 26-Bit wiegand communication.

It uses DK Prox proprietary software. Maximum read range varies depending on the model.

The readers are sealed in epoxy, making them vandal-resistant and are ideal for both indoor and outdoor applications.

Installation

To achieve optimal performance from the DK Prox card readers, do not mount the reader on metal surfaces. Mounting these readers on a metal surface will decrease the read range of the device. These readers require 0.2 Amp at 12 Volt DC input power. If power is supplied by a plug-in transformer, be sure the output is rated as required and that the transformer is U.L. Listed. LED (yellow wire) and Beeper (blue wire) are activated by ground. **DO NOT** connect these to 12 VDC.

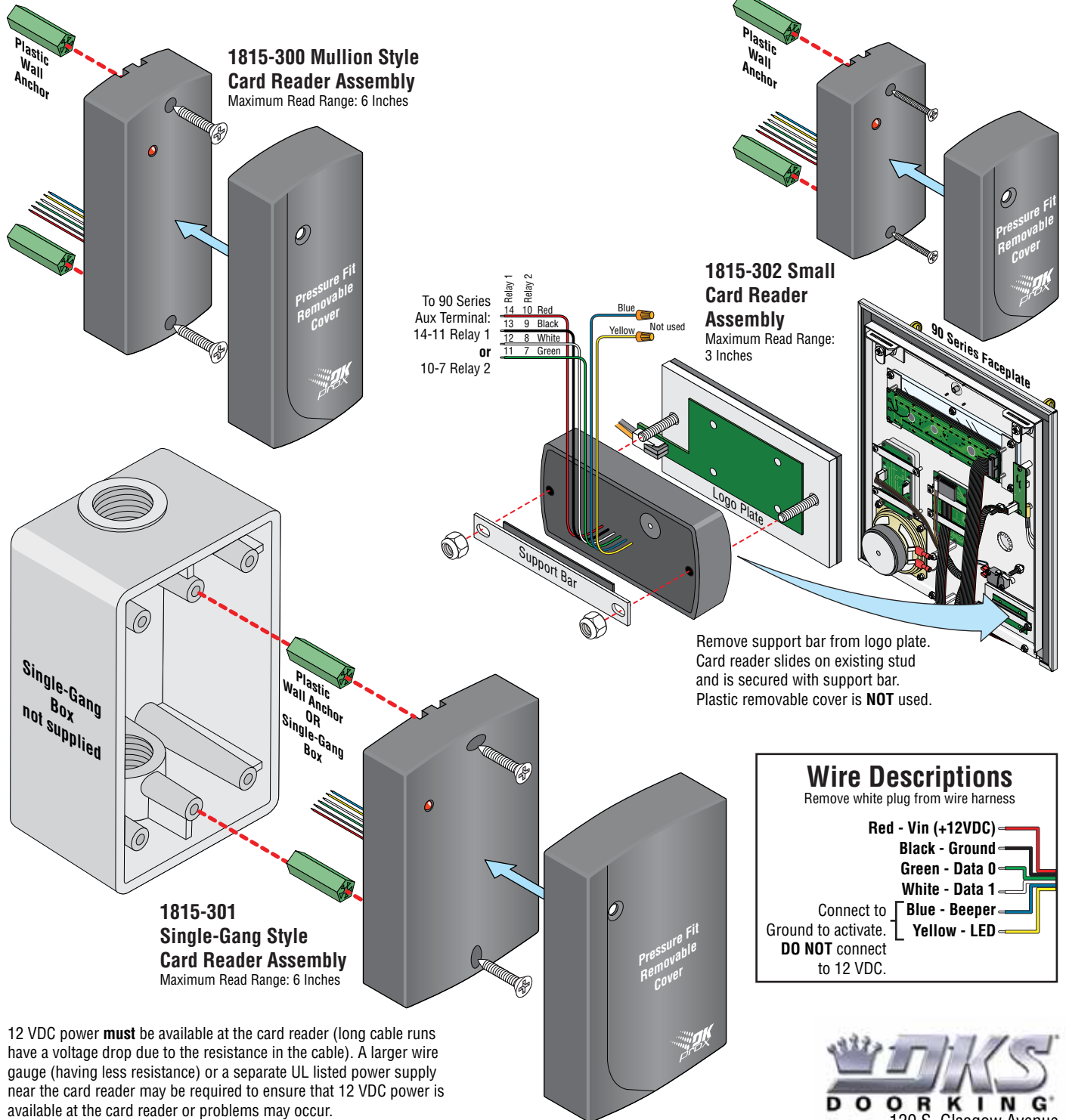

12 VDC power **must** be available at the card reader (long cable runs have a voltage drop due to the resistance in the cable). A larger wire gauge (having less resistance) or a separate UL listed power supply near the card reader may be required to ensure that 12 VDC power is available at the card reader or problems may occur.