

ILLUSTRATED PARTS BREAKDOWN - IPB

Bill of Materials - BOM

1837 Surface Mount
1837-080 Stainless Steel, 1837-081 Gold Plated

Item	Part Number	Quantity	UM	Description
10	1817-004	1	EA	Cover Plastic 8 Line
15	1817-006	1	EA	Cover Plastic Lights
25	1804-023	1	EA	Decal FCC
30	1804-044	1	EA 1837-081 only	Hole Plug - Gold
35	1804-042	1	EA	Hole Plug
40	1400-009	1	EA	Decal Identification
45	1804-039	2	EA	Retaining Strip Keypad
50	1895-016	1	EA	Keypad 10 Pin Alph/Num Header
50	1895-018	1	EA 1837-081 only	Keypad Alph/Num Header Gold
51	1804-038	1	EA	Wire Ribbon Cable Assy 10 Cond
55	2599-008	1	EA	Label Patent
57	1998-010	1	EA	PCB Microphone Short, SMT
58	1897-053	1	EA	Gasket, Microphone
60	2356-010	2	EA	PCB LED Light Straight
65	2900-905	2	EA	Standoff Aluminum 7/16" 6-32
70	4001-035	2	EA	Lock N16058BDxSFx2K Key 16120
70	4001-036	2	EA 1837-081 only	Lock Gold N16058BDxSFx2K
73	1702-501	2	EA	Cam 7/8"
75	2900-907	4	EA	Standoff Aluminum 9/16" 6-32
80	2902-006	2	EA	Nut Nylon Lock 10-32
85	2902-002	6	EA	Nut Nylon Lock 4-40
90	2902-003	27	EA	Nut Nylon Lock 6-32
92	2802-040	2	EA	Washer Push on Clamp
95	1837-010	1	EA	PCB Modem Prog/Electr Dir Phone
100	1896-012	1	EA	Display LCD Assy 8 Line
103	1860-029	4	EA	Washer Nylon #6 16FN006062
105	1817-190	1	EA	Speaker Assembly Oval
107	1804-012	1	EA	Screw Nylon Pan Head 6-32x3/16
109	1817-197	1	EA	Speaker Gasket Oval
110	1817-191	1	EA	Speaker Gasket Oval
111	2616-006	2	EA	Screw Phillips Head 6-32x3/16
115	2905-001	4	EA	Screw Round Head 6-32 x 1/4"
120	2905-003	2	EA	Screw Round Head 6-32 x 1/2"
130	1804-016	6	EA	Screw Truss Head 6-32 x 3/16"
145	3002-004	10	EA	Spacer Nylon 6 x 7/16"
150	1810-101	1	EA	Box Phone Slant
155	1837-050	1	EA	Faceplate Surface 8 Line
155	1837-053	1	EA 1837-081 only	Faceplate Surface 8 Line Gold
156	1837-025	1	EA	Subplate Surface 8 Line
158	2600-734	1	EA	Nameplate Plastic DKS Small
159	1897-050	2	EA	Gasket Support Thick 1/16"
160	1804-024	1	EA	Switch Micro No NC C
165	1814-032	1	EA	Plate - Switch 3 Button
170	1814-049	1	EA	Terminal 20 Pin
175	1804-060	1	EA	Transformer 16.5 VAC 20VA plug
177	1508-060	1	EA	Transformer 16.5 VAC 40 VA
179	1860-029	10	EA	Washer Nylon #6 16FN006062
180	1800-018	2.91	FT	Weather Strip .125"x .187"
195	7082-059	1	EA	Wire 8.5" Green 18 AWG Strd
200	1816-042	1	EA	Wire-20 Con Ribbon Long
215	1804-040	1	EA	Wire Telephone Line Cord
220	1804-028	3	EA	Mount Wire Clip
231	1814-140	1	EA	Button Assembly Chrome A
231	1814-143	1	EA 1837-081 only	Button Assembly Gold A
232	1814-141	1	EA	Button Assembly Chrome Z
232	1814-144	1	EA 1837-081 only	Button Assembly Gold Z
233	1814-142	1	EA	Button Assembly Chrome Call
233	1814-145	1	EA 1837-081 only	Button Assembly Gold Call
235	1815-025	1	EA	Remote Program Pac Windows
240	1835-065	1	EA	Manual - Owner's
	1835-066	1	EA	Manual - User's
245	3002-021	10	EA	Spacer Nylon 6 x 3/8"
255	2600-884	1	EA	Label E.T.L. Separable
270	1876-025	2	EA	Ferrite Snap-on Filter Steward
280	1835-147	1	EA	Memory 3000 Phone Card APB
281		1	EA	Wire Harness 1837 Front Panel

1837 Surface Mount - Faceplate

- 1837-080 and 1837-081
- 1837-081 Gold Plated Only

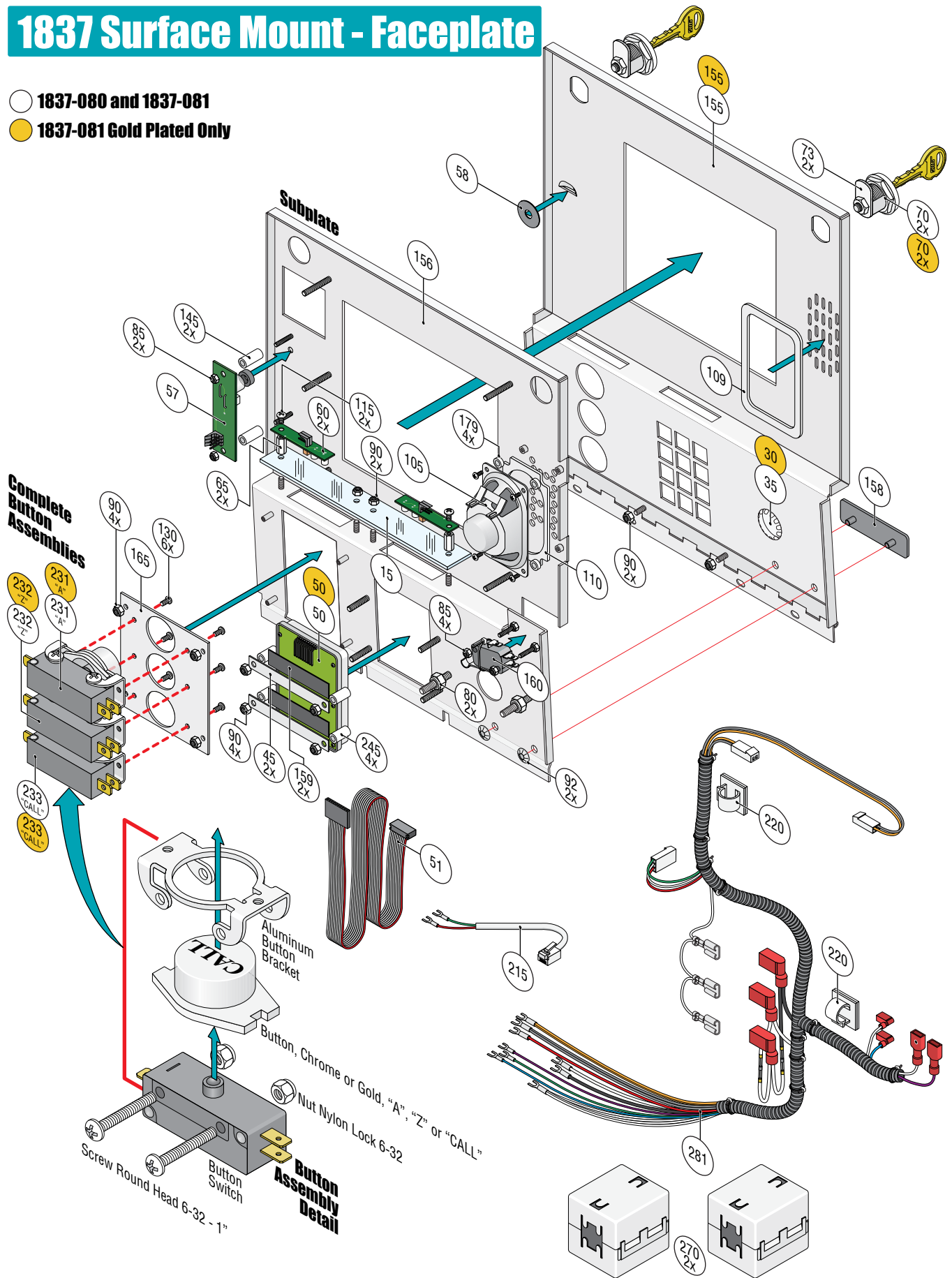

ILLUSTRATED PARTS BREAKDOWN - IPB

Bill of Materials - BOM

1837 Flush Mount
1837-084 Stainless Steel, 1837-085 Gold Plated

Item	Part Number	Quantity	UM	Description
10	1895-016	1	EA	Keypad 10 Pin Alph/Num Header
11	1804-038	1	EA	Wire Ribbon Cable Assy 10 Cond
15	1817-004	1	EA	Cover Plastic 8 Line
20	1804-023	1	EA	Decal FCC
25	1804-044	1	EA 1837-085 only	Hole Plug - Gold
30	1804-042	1	EA	Hole Plug
30	1895-018	1	EA 1837-085 only	Keypad Alph/Num Header Gold
40	1400-009	1	EA	Decal Identification
45	1804-039	2	EA	Retaining Strip Keypad
55	2599-008	1	EA	Label Patent
57	1998-010	1	EA	PCB Microphone Short, SMT
58	1897-053	1	EA	Gasket, Microphone
60	4001-035	2	EA	Lock N16058BDxSFx2K Key 16120
60	4001-036	2	EA 1837-085 only	Lock Gold N16058BDxSFx2K
61	1800-018	2.91	FT	Weather Strip .125" x .187"
63	1702-501	2	EA	Cam 7/8"
70	2902-006	2	EA	Nut Nylon Lock 10-32
75	2902-002	6	EA	Nut Nylon Lock 4-40
80	2902-003	22	EA	Nut Nylon Lock 6-32
85	1837-026	1	EA	Subplate Flush 8 Line
90	1837-051	1	EA	Faceplate Flush 8 Line
90	1837-054	1	EA 1837-085 only	Faceplate Flush 8 Line Gold
91	2600-734	1	EA	Nameplate Plastic DKS Small
92	2802-040	2	EA	Washer Push on Clamp
93	1814-101	1	EA	Box Phone Flush
94	1897-050	2	EA	Gasket Support Thick 1/16"
95	1814-032	1	EA	Plate - Switch 3 Button
100	1896-012	1	EA	Display LCD Assy 8 Line
105	1837-010	1	EA	PCB Modem Prog/Electr Dir Phone
110	2905-001	2	EA	Screw Round Head 6-32 x 1/4"
115	2905-003	2	EA	Screw Round Head 6-32 x 1/2"
125	1804-016	6	EA	Screw Truss Head 6-32 x 3/16"
135	2900-905	4	EA	Standoff Aluminum 7/16" 6-32
140	3002-004	10	EA	Spacer Nylon 6 x 7/16"
145	1817-190	1	EA	Speaker Assembly Oval
150	1817-191	1	EA	Speaker Gasket Oval
151	1817-197	1	EA	Speaker Gasket Oval
153	1860-029	10	EA	Washer Nylon #6 16FN006062
155	1804-024	1	EA	Switch Micro No NC C
165	1814-049	1	EA	Terminal 20 Pin
170	1804-060	1	EA	Transformer 16.5 VAC 20VA plug
173	1508-060	1	EA	Transformer 16.5 VAC 40 VA
190	7082-059	1	EA	Wire 8.5" Green 18 AWG Strd
195	1816-042	1	EA	Wire-20 Con Ribbon Long
210	1804-040	1	EA	Wire Telephone Line Cord
215	1804-028	3	EA	Mount Wire Clip
230	1814-140	1	EA	Button Assembly Chrome A
230	1814-143	1	EA 1837-085 only	Button Assembly Gold A
231	1814-141	1	EA	Button Assembly Chrome Z
232	1814-142	1	EA	Button Assembly Chrome Call
233	1814-144	1	EA 1837-085 only	Button Assembly Gold Z
234	1814-145	1	EA 1837-085 only	Button Assembly Gold Call
235	1835-065	1	EA	Manual - Owner's
	1835-066	1	EA	Manual - User's
240	1815-025	1	EA	Remote Program Pac Windows
245	3002-021	4	EA	Spacer Nylon 6 x 3/8"
247	2600-884	1	EA	Label E.T.L. Separable
255	1876-025	2	EA	Ferrite Snap-on Filter Steward
265	1835-147	1	EA	Memory 3000 Phone Card APB
266		1	EA	Wire Harness 1837 Front Panel

1837 Flush Mount - Faceplate

- 1837-084 and 1837-085
- 1837-085 Gold Plated Only

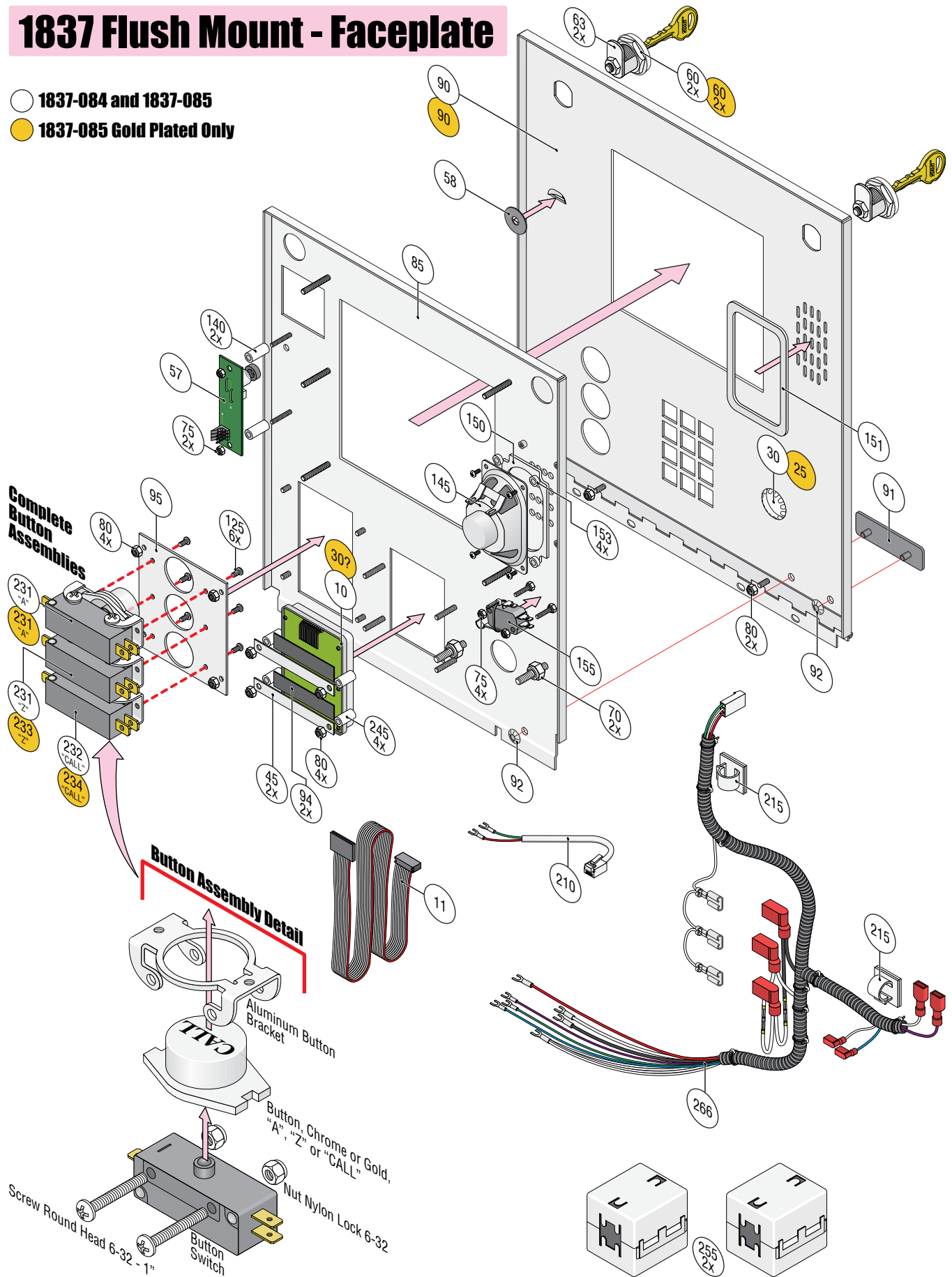

ILLUSTRATED PARTS BREAKDOWN - IPB

Bill of Materials - BOM

1837 Wall Mount
1837-089 Stainless Steel

Item	Part Number	Quantity	UM	Description
15	1817-004	1	EA	Cover Plastic 8 Line
20	1804-023	1	EA	Decal FCC
30	1804-042	1	EA	Hole Plug
40	1400-009	1	EA	Decal Identification
45	1804-039	2	EA	Retaining Strip Keypad
50	1895-016	1	EA	Keypad 10 Pin Alph/Num Header
51	1804-038	1	EA	Wire Ribbon Cable Assy 10 Cond
55	2599-008	1	EA	Label Patent
57	1998-010	1	EA	PCB Microphone Short, SMT
60	1702-514	1	EA	Cam Wall Mnt. Offset
64	4001-035	1	EA	Lock N16058BDxSFx2K Key 16120
70	2902-006	3	EA	Nut Nylon Lock 10-32
75	2902-002	6	EA	Nut Nylon Lock 4-40
80	2902-003	27	EA	Nut Nylon Lock 6-32
85	1835-057	1	EA	Faceplate Wall Mnt. Keypad
89	1837-057	1	EA	Faceplate Wall Mnt 8 Line Dsp
90	1837-027	1	EA	Subplate Wall Mnt. 8 Line
91	2600-734	1	EA	Nameplate Plastic DKS Small
92	2802-040	2	EA	Washer Push on Clamp
93	1835-100	1	EA	Box Wall Mnt.
94	1897-050	2	EA	Gasket Support Thick 1/16"
95	1814-032	1	EA	Plate - Switch 3 Button
100	1896-012	1	EA	Display LCD Assy 8 Line
102	1860-029	22	EA	Washer Nylon #6 16FN006062
103	2342-010	1	EA	PCB LED Front Panel Light
105	1837-010	1	EA	PCB Modem Prog/Electr Dir Phone
107	1804-012	6	EA	Screw Nylon Pan Head 6-32x3/16
109	2904-001	8	EA	Screw Round Head 4-40 x 1/4"
115	2905-003	4	EA	Screw Round Head 6-32 x 1/2"
145	1817-190	1	EA	Speaker Assembly Oval
150	1817-191	1	EA	Speaker Gasket Oval
151	1817-197	1	EA	Speaker Gasket Oval
155	1804-024	1	EA	Switch Micro No NC C
165	1814-049	1	EA	Terminal 20 Pin
170	1804-060	1	EA	Transformer 16.5 VAC 20VA plug
173	1508-060	1	EA	Transformer 16.5 VAC 40 VA
190	7082-059	1	EA	Wire 8.5" Green 18 AWG Strd
195	1816-042	1	EA	Wire-20 Con Ribbon Long
208	1800-018	2.91	FT	Weather Strip .125"x .187"
210	1804-040	1	EA	Wire Telephone Line Cord
215	1804-028	3	EA	Mount Wire Clip
230	1814-140	1	EA	Button Assembly Chrome A
231	1814-141	1	EA	Button Assembly Chrome Z
233	1814-142	1	EA	Button Assembly Chrome Call
235	1835-065	1	EA	Manual - Owner's
	1835-066	1	EA	Manual - User's
245	1815-025	1	EA	Remote Program Pac Windows
250	3002-021	10	EA	Spacer Nylon 6 x 3/8"
260	1897-053	1	EA	Gasket, Microphone
263	2600-884	1	EA	Label E.T.L. Separable
270	1876-025	2	EA	Ferrite Snap-on Filter Steward
280	1835-147	1	EA	Memory 3000 Phone Card APB
281		1	EA	Wire Harness 1837 Front Panel

