

# 470 Series Grade 2 Deadbolts

## Auxiliary Locks

**SARGENT**  
**ASSA ABLOY**

### Specifications

For Doors	1-3/4" (44mm) to 2-3/8" (61mm) door thickness [except 475 with 2-1/16" (53mm) maximum thickness.] (1-3/8" door optional as 1-Option)
Door Prep	1-1/2" dia. (38mm) hole standard for all functions 2-1/8" dia. (54mm) hole (161 door prep) for 474 and 475 only with adapter ring provided
Backsets	2-3/8" (61mm) or 2-3/4" (70mm) adjustable backset
Strike	406 Strike standard 407 1/4" Radius Strike (Specify option 13-) 408 Flat Lip Strike 4-7/8" x 1-1/4" (Specify option 28-)
Bolt	Brass with hardened steel pin 5/8" (16mm) x 13/16" (21mm) x 1" (25mm) throw
Cylinder	Brass, 6 pin cylinder 2 keys provided
Masterkeying	Can be masterkeyed. Construction key system available
ANSI/BHMA	Designed to meet A156.36 Grade 2
Front	Stamped brass 2-1/4" (57mm) x 1" (25mm) wide with filler for 1-1/8" (29mm) wide
Hand	Universal – non handed
Mechanical Options	Cylinder Options see page 11-12 1- 1-3/8" (35mm) thick door adapter 13- Front & strike with 1/4" (6mm) radius corners 15- Drive-in adjustable backset bolt x 26D only (Not Grade 2) 28- 408 Flat lip strike, 4-7/8" (124mm) x 1-1/4" (32mm). ANSI A115.2
Finishes	03, 04, 10, 10B, 10BE, 14, 15, 26, 26D, BSP, WSP

### How To Order

10-20-	475	26D
Options	Series x Function	Finish
Mechanical Options this page	474 475	03, 04, 10, 10B, 10BE, 14, 15, 26, 26D, BSP, WSP
Cylinder Options page 11-12	479	

### Packaging — 470 Series

Approximate Shipping Weights	
2 lbs./Box	10 Boxes/Case

### Functions

#### 474 Double Cylinder

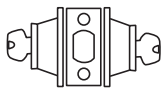

- Key from either side operates deadbolt
- \* Use **only** on rooms with more than one exit

#### 475 Single Cylinder x Thumbturn

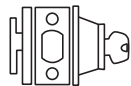

- Key outside operates deadbolt
- Thumb turn inside operates deadbolt

#### 479 Thumbturn Inside Only



- Thumb turn inside operates deadbolt
- Inside mounting only

### 470 Series Deadbolt

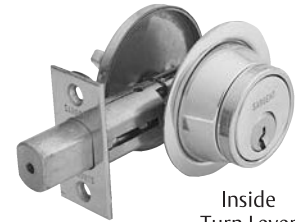

Inside  
Turn Lever  
ADA Compliant

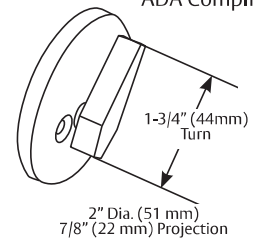

### Strikes

#### 406 Strike Standard

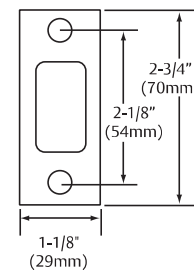

#### 407 Radius Strike 13- Option Includes Radius Front

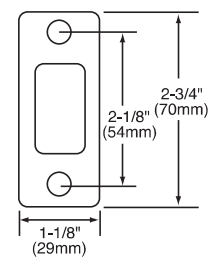

#### 408 Flat Lip Strike 28- Option

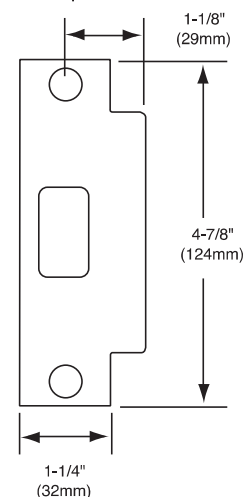

Copyright © 2007, SARGENT Manufacturing Company. All rights reserved. Reproduction in whole or in part without the express written permission of SARGENT Manufacturing Company is prohibited. Patent pending and/or patent www.assaabloyds.com/patents.